

上海瑞熙贸易有限公司 Shanghai Olimy Co.,Ltd

首件检验 First piece inspection report

产品编号 Part No.	3384593	产品名称 Part	Filter top	颜色 Color	Grey	生产日期 Date	2019-4-11
------------------	---------	--------------	------------	-------------	------	--------------	-----------

产品简图:
Photo of product:

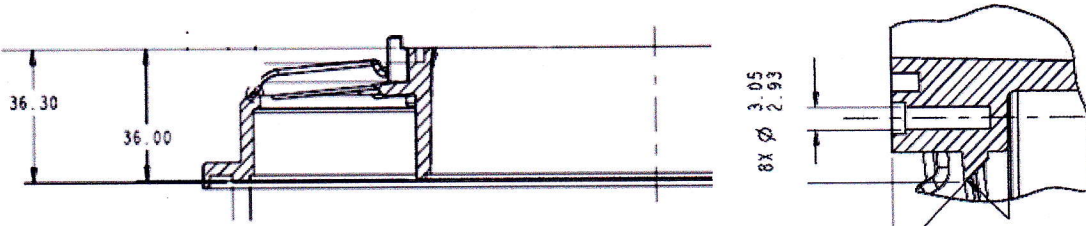

检验项目 Inspection item	检验内容及技术要求 Specification	检验方式或器具 EQUIP	检验记录 Record					判定Result
			1	2	3	4	5	
外观 Appearance	产品与色板对比无明显色差 No obvious chromatic aberration according to sample	与封样件对比目测 Visual	OK	OK	OK	OK	OK	OK(✓)NG()
	产品无翘曲变形,料花,油污,烧焦,缩水,缺料等不良 No obvious deformation, pigmentosa, flow marks on the surface	目视 Visual	OK	OK	OK	OK	OK	OK(✓)NG()
	孔内不能有飞边 No flash inside holes.		OK	OK	OK	OK	OK	OK(✓)NG()
	柱子不能有断裂 No breakage or crevice		OK	OK	OK	OK	OK	OK(✓)NG()
	网子不能有破损 No damage on mesh screen		OK	OK	OK	OK	OK	OK(✓)NG()
尺寸 Dimensions	36.3±0.8	3D	35.847	35.902	35.943	35.924	35.989	OK(✓)NG()
	36±0.3		35.793	35.863	35.712	35.838	35.896	OK(✓)NG()
	2.93~3.05	2D	2.945	2.964	2.993	2.981	2.990	OK(✓)NG()

备注: 开机生产, 修模及每日8:00均需进行首件检验, 检验数量为5PCS
Remark: The machine needs to be inspected before starting up production every day, the first inspection is required at eight o'clock every day, 5pcs to be checked each time.

结论: **合格**
Result: **OK**

检验员: **曹雪红**
Checked by: **曹雪红**

检验日期: **2019-4-11**
Inspect date: **2019-4-11**